

VERSAMAX™

SOLID PHENOLIC LOCKERS

AMERICA'S MOST COMPLETE LOCKER LINE®

SUPERIOR
LOCKERS



VERSAMAX™ SOLID PHENOLIC LOCKERS

Superior® Lockers for Superior® Satisfaction

VersaMax™ Solid Phenolic lockers are engineered to the same high level of integrity found throughout our Superior® locker line.

The unique qualities of phenolic resin offer many value added benefits:

- ✓ **Environmentally smart**
- ✓ **Moisture resistant, perfect for wet or damp areas**
- ✓ **Mold and mildew resistant**
- ✓ **Many color and finish options**
- ✓ **Laminate surface is graffiti and scratch resistant**
- ✓ **Standard Phenolic material is Class 2, Class B Fire Rated
ASTM E84 Class 1, Class A Fire Rated is available as an upgrade**



Superior® Styles for Superior® Space Management

VersaMax™ Solid Phenolic lockers are available in a variety of locker styles to meet your specific storage needs.

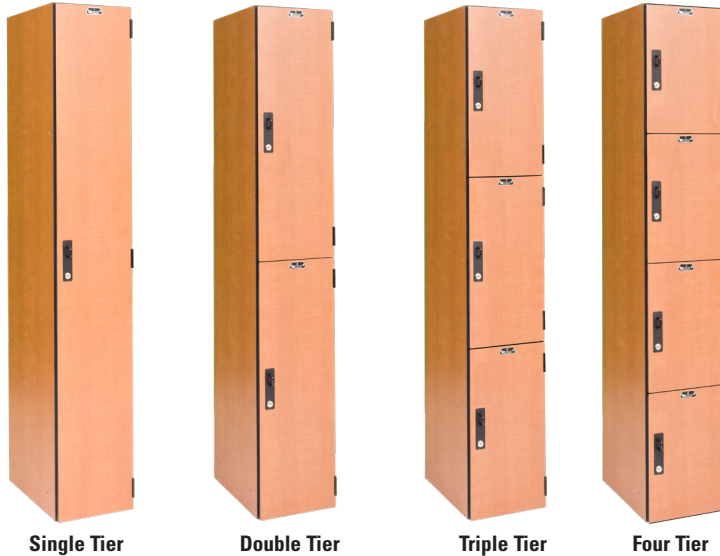

Single Tier

Double Tier

Triple Tier

Four Tier

- **Single Tier** lockers are perfect for hanging of longer garments
- **Double Tier** lockers offer plenty of height for hanging coats and garments while using half the floor space of a single tier locker
- **Triple Tier** lockers are our most economical wardrobe locker allowing hanging garments to be draped from the coat hook
- **Four Tier** lockers provide ample storage for larger personal items like backpacks, totes, etc.

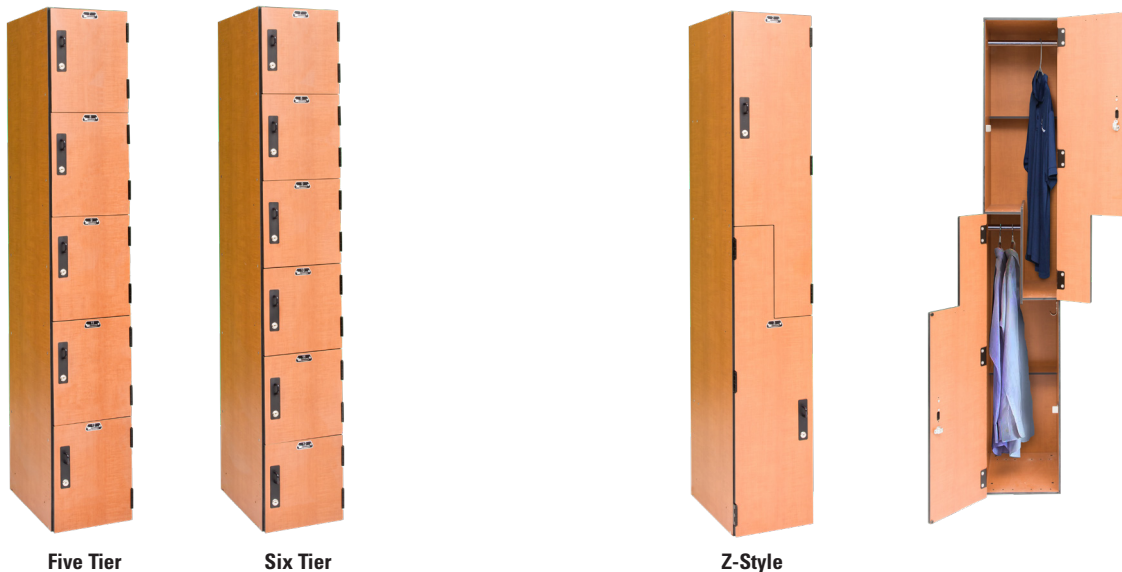

Five Tier

Six Tier

Z-Style

- **Five tier** lockers are available in 12" and 14.4" high openings allowing for storage of personal belongings
- **Six Tier** lockers are the most economical storage solution for purses, bags, phones and other smaller personal items
- **Z-Style Lockers** are the perfect compromise between single and double tier lockers offering the perfect solution when space is at a premium, but hanging of longer garments is needed.

VERSAMAX™ SOLID PHENOLIC LOCKERS



STOCK PHENOLIC LOCKER SIZES

Tier	Width	Depth	Opening Height	Overall Height
Single Tier	12"	18"	72"	72"
Double Tier	12"	18"	36"	72"
Six Tier	12"	18"	12"	72"
Z-Tier	12"	18"	42"	72"

Available from stock with three locking options:
Padlock Hasp, Key cam lock, Digitech electronic locks.
STOCK COLOR 7284-58 Figured Annigre

PRODUCTION PHENOLIC LOCKER SIZES

Tier	Width	Depth	Opening Height	Overall Height
Single Tier	9", 12", 15", 18", 24"	12", 15", 18", 20", 24"	36", 48", 60", 72"	36", 48", 60", 72"
Double Tier	9", 12", 15", 18", 24"	12", 15", 18", 20"	18", 24", 30", 36"	36", 48", 60", 72"
Triple Tier	9", 12", 15", 18"	12", 15", 18", 20"	12", 20", 24"	36", 60", 72"
Four Tier	9", 12", 15", 18"	12", 15", 18", 20"	12", 15", 18"	48", 60", 72"
Five Tier	9", 12", 15", 18"	12", 15", 18", 20"	12", 14.4"	60", 72"
Six Tier	9", 12", 15", 18"	12", 15", 18", 20"	12"	72"
Z-Style	12", 15", 18"	12", 15", 18", 20"	36/24", 42"/30"	60", 72"
Sport	18", 24" 30", 36"	18", 20", 24"	N/A	72", 84"

VERSAMAX™ SOLID PHENOLIC LOCKERS

Superior® Construction for Superior® Durability

DOORS:

Our door over body design provides several major benefits

- Allows air-flow from all directions for maximum locker ventilation without unsightly door perforations
- Provides an added 2-3" of clear locker opening which can provide up to 25% more storage space vs conventional door in frame lockers
- Esthetically pleasing modern design with clean shadow lines and reveals
- Doors are 1/2" thick solid phenolic

BODY:

Construction of our locker body is second to none

- Interlocking components by means of dado and mortise & tenon joints reinforced with stainless steel screws for perfect alignment and maximum strength
- Top, bottoms and shelves are 3/8" thick solid phenolic
- Sides are 5/16" thick solid phenolic
- Backs are 1/4" thick solid phenolic

HARDWARE AND ACCESSORIES:

We utilize the industry's best available hardware to meet the high expectations of our customers.

- **Door Hinges** are 14 gauge 5-knuckle 304 stainless steel with eased top and bottom edges for safety allow doors to open a full 180-degrees.
- **Hinges** are powder coated black to match phenolic core
- **Padlock Hasp** is fabricated from 11 gauge 304 stainless steel
- **Hanging garment J-Hooks** are 304 stainless steel
- **Door Pull** is 304 Stainless Steel and powder coated black to match phenolic core
- **Number Plates** are aluminum and included at no additional charge. They are etched with numbers 1 and up unless otherwise specified. Doors are pre-drilled to allow for easy installation of number plates
- **Assembly Hardware:** Stainless Steel tamper resistant torx head through-bolts are used for locker component assembly and hardware installation

VARIOUS LOCKING OPTIONS:



Padlock Hasp

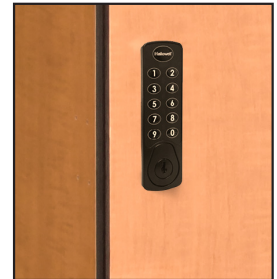

DigiTech™ H1
Electronic Locks



Built-In Key Cam Locks



DigiTech™ RFID
Electronic Locks



Built-In Combination Locks

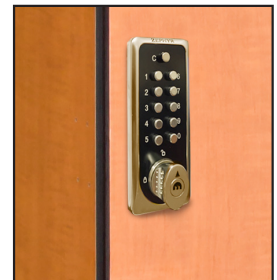

Mechanical Shared Use
Locks



Coin or Token Locks



ADA Compliant
Locks Available

VERSAMAX™ SOLID PHENOLIC LOCKERS

Superior® Design for Superior® Performance

STANDARD FEATURES

- ✓ 3/8" Panel Construction with 1/4" Back
- ✓ Shoulder Pad Storage Area
- ✓ Security Box with 1/2" thick door
- ✓ Standard with padlock hasp
- ✓ Open Shelf Area
- ✓ Chrome Coat Rod
- ✓ Clothing Hooks
- ✓ Ventilated Foot Locker With Seat

Available Sizes

Widths: 18", 24", 30", 36"

Depths: 18", 20", 24"

Heights: 72", 84"



Shown with
optional DigiTech
Electronic Lock

OPTIONAL FEATURES



Shoulder Pad Rack



Shoulder Pad & Helmet Rack

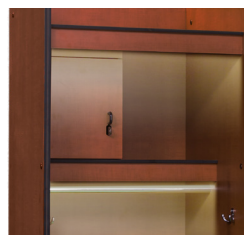

LED Lighting Kits



Optional USB & 110w Power Outlet
in rear of security box



Name Plate Holders

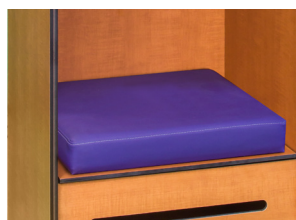

Seat Cushion



Foot Locker Ventilation Kit
Two 110w fans move air thru foot locker

VERSAMAX™ SOLID PHENOLIC LOCKERS



Benches & Pedestals

Locker Benches are 9-1/2" wide x 3/4" thick. Bench tops are standard in one foot increments from 3' thru 12'. Non-standard lengths are available on special order (pedestal requirement will be for next standard size up).

BENCH TOP LENGTH	3' - 5'	6' - 8'	9' - 12'
PEDESTALS REQUIRED	2	3	4

Pedestal spacing not to exceed 40" O.C.



SHOWN WITH 4810
PEDESTALS



4805 Heavy Duty Steel Pedestal

fabricated from 14 gauge steel tube with 11 gauge formed flanges
Color: Tan



8032 Adjustable Steel Pedestal

with cast aluminum base and concealed anchoring to floor
Color: Tan



4810 EXTRA Heavy-Duty Cast Iron Pedestal

with 6" diameter top and bottom flanges
Color: Tan



4820 Aluminum Movable Pedestal

includes holes for optional permanent anchoring to floor
Color: Tan



4825 Stainless Steel Movable Pedestal

fabricated from 16 gauge stainless steel. Designed for movable and fixed use
Color: Unpainted

VersaMax™ lockers use Formica® engineered surfaces, world's largest manufacturer of Phenolic panels

18 DESIGNER COLORS

SOLID COLOR FINISH

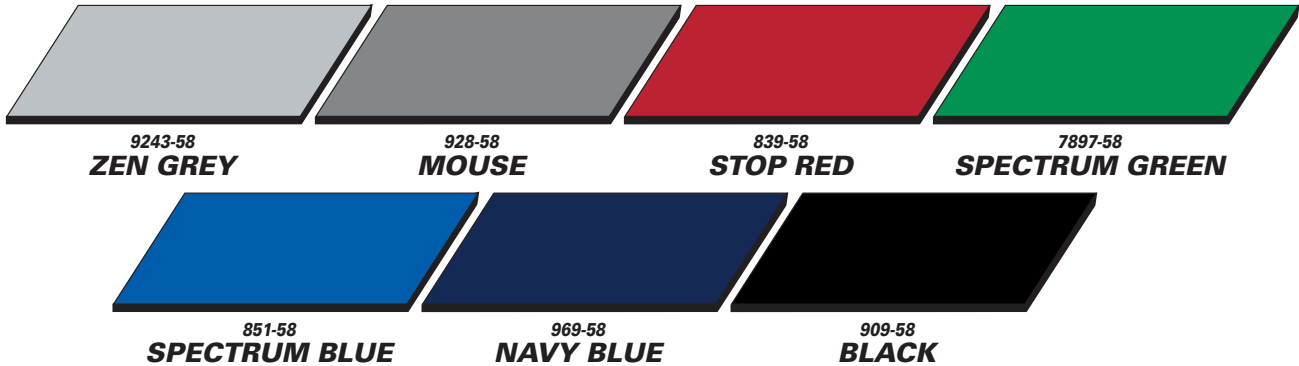

SPECKLE FINISH

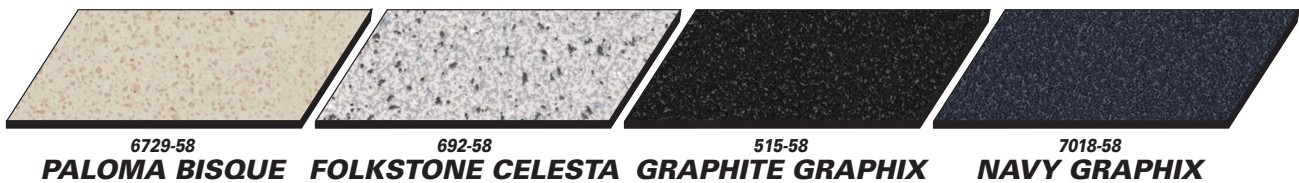

WOODGRAIN FINISH

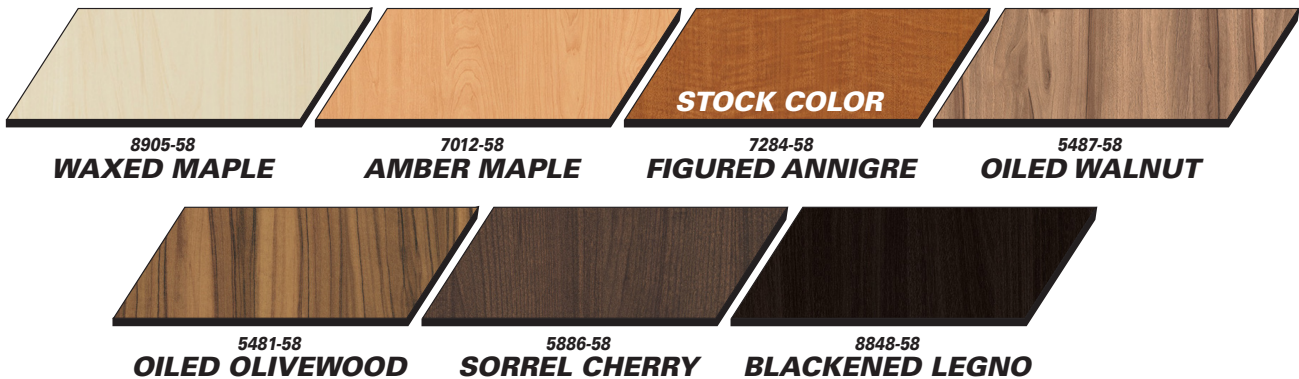

Colors shown are an approximate representation of the actual color. Please do not make your final color selection from printed media or Internet images, as they may not be 100% accurate. For a more accurate color selection call 800-776-1342 or e-mail us at info@ListIndustries.com to request actual color samples.



1-800-776-1342
ListIndustries.com



401 Jim Moran Blvd., Deerfield Beach, FL 33442